

MICROSAFE X6

OXYGEN DOSING EQUIPMENT



BENEFITS

OXYGENATION
OF MUSTS
AND WINES

MAXIMUM
DOSING
ACCURACY

VERY
SIMPLE
TO USE

MICROSAFE X6



Microsafe X6 is an oxygenation system equipped with six delivery points, designed **for all applications that don't require micro-dosing**. It doses discontinuously, changing the delivery point every 10 minutes, cyclically repeating the oxygen dose every hour.

 **BENEFITS**

1 OXYGENATION OF MUSTS AND WINES

- Allows optimal preparation of the pied de cuv e.
- Promotes the fermentation process.
- Assists stabilisation of colour when the alcoholic content is greater than 8% vol.
- Removes reduction in combination with Ellagitan, Desulfur or Bois evage, substituting the need for any decanting.
- The resulting wines are more open, fresh and free from reductive notes that inhibit their real aromatic perception.

2 MAXIMUM MEASUREMENT ACCURACY

Thanks to cutting-edge electronics, Microsafe X6 is able to continuously measure the temperature and delivery pressure, making real-time calculations and correcting the gas dosage.

3 EXTREME SIMPLICITY OF USE

Guaranteed by the easy setting of the work parameters:

- Number of delivery device (1-6)
- Volume of oxygenation tank (hL)
- Oxygen to be delivered (mg/L/day)

TECHNICAL CHARACTERISTICS

- Adaptability to tanks from 200 hL to 8,000 hL, with 10 hL steps.
- Delivery: from 1 mg/L/day to 20 mg/L/day, with 0.1 mg/L steps.
- Maximum daily dosage of oxygen: 15 kg.
- Base operating cycle: 24 hours.
- For single outlet: maximum daily dosage of oxygen equal to 2.5 kg (equivalent to 3.12 mg/L for an 8,000 hL tank).

PLC SCREEN

The PLC makes the user settings easy and intuitive.

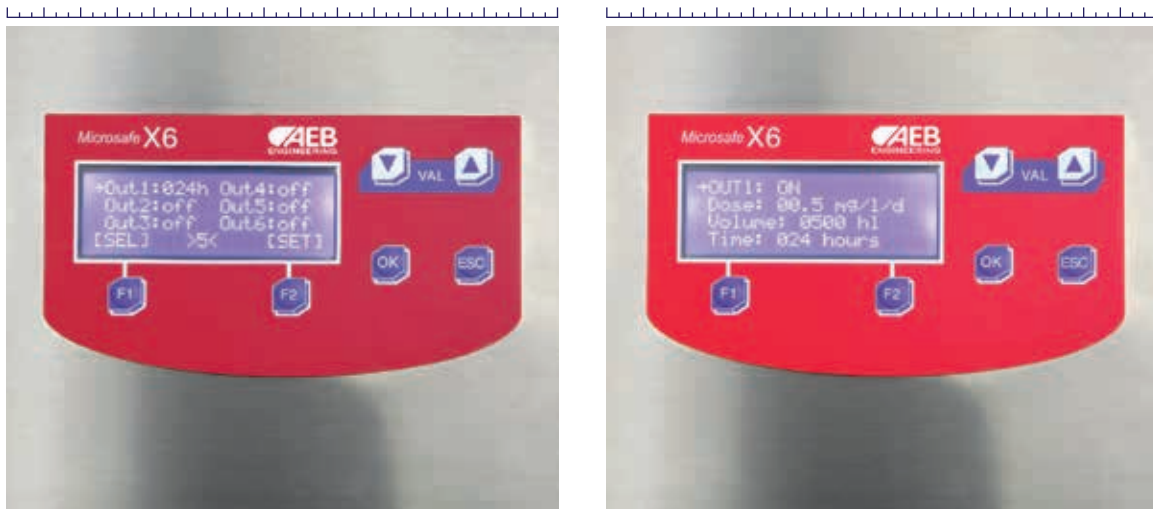

INCLUDED ACCESSORIES

DOSING DIFFUSER

CHARACTERISTIC	STEEL
Porosity	Approx. 5 micron
Resistance	High
Cleanliness	Easy



OXYGEN INJECTION BAR

The oxygen can be introduced by

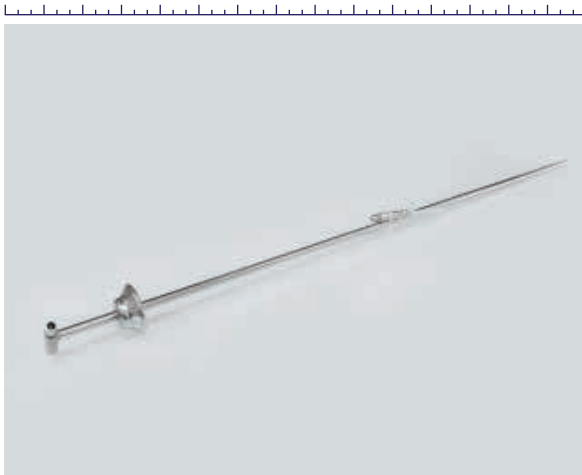

FIXED BAR

Introduction of oxygen from below using a 1 metre bar with Garolla 50 fitting to be inserted when the tank is empty.

EXTRACTABLE BAR

Introduction of oxygen through a 1 metre bar, with cup. This system, unlike the one with a fixed bar, can also be inserted in full tanks.

OPERATING PRINCIPLE

The bar must be assembled by inserting the closure first, then an O-ring, the Teflon shim, the second O-ring, and then the cup with Garolla 50 fitting, (screwing it onto the closure).